

### USER MANUAL UTL-9 FLAT-PANEL LED

#### Each Set Contains:

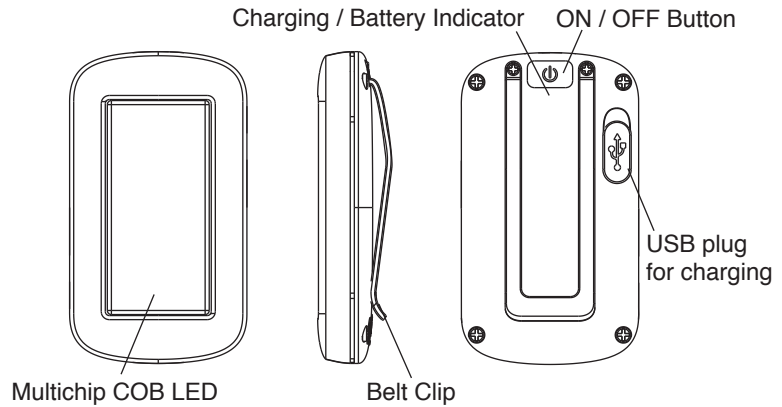
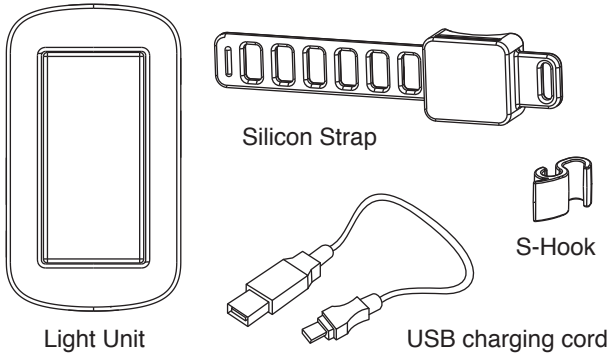

#### READ BEFORE USE

- Check before you ride to ensure the light unit is attached securely. NEVER use a damaged rubber bracket.
- Keep the light away from children.
- Charging, discharging, and storing in high temperatures will deteriorate the rechargeable battery.
- Do not leave the light in a vehicle or place it near a heater.
- This unit is IPX4 (not 100% waterproof). If the light becomes dirty with mud, Please clean it by moistened wipe (or with mild soap if necessary) and dry it completely. Otherwise, it may cause failure.
- Never wipe the light with paint thinner, benzene or alcohol; it may result in damage.

#### PRECAUTIONS ON CHARGING

- We recommend using 0.5A USB battery charger or computer (USB2.0 and up)
- NEVER charge the unit under sunlight or in a vehicle parked under direct sunlight.
- The recommended charging environment is when the ambient temperature is between 5 and 40°C (41°F and 104 °F).
- Before charging, please check if there is no sign of dust or other foreign objects in the USB plug.
- NEVER expose the light to vibrations while charging.
- When your PC is in sleep mode, the light may not be fully charged.
- Once charging is completed, be sure to disconnect the USB plug.
- Do not charge over 15 hours continuously.
- Charging time and run time are approximate values, will vary by environmental and user conditions.
- If the run time & luminosity are significantly reduced even after proper charging, the rechargeable battery might be nearing the maximum amount of charging cycles. Dispose of the battery as described in "DISPOSAL PRECAUTIONS".

#### STORAGE WHEN NOT IN USE

When the light is idling for a long period of time, make sure the storage location is not hot or humid. Charge the battery for about 20 minutes every 6 months.

#### DISPOSAL PRECAUTIONS

When disposing the light, remove the built-in battery and dispose the rechargeable battery according to local regulations.

### 1. HOW TO CHARGE

 **Charging will deactivate the TRY-ME feature.**  
**TIPS Always charge light before USE.**

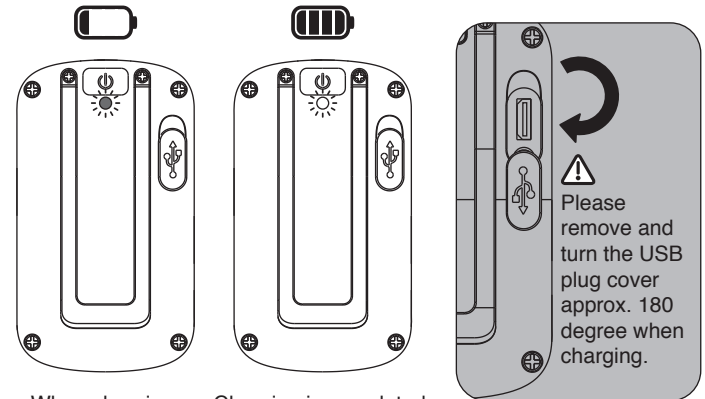

**MAKE SURE THE USB COVER IS COMPLETELY SEALED BY THE USB COVER AFTER CHARGING**

Charging Time: **Approx. 3hrs**

### 2. MOUNT ON YOUR BIKE

Light is designed to mount on a tube diameter of **21.5mm to 31.8mm**. The light is slim fit and can attach on silicon strap directly.

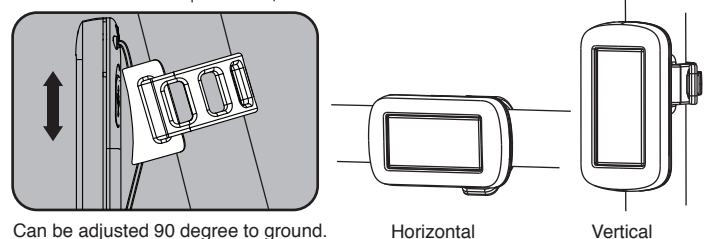

 **TIPS**

### 3. HOW TO OPERATE

The light operates by the power switch. Press the switch to change mode.

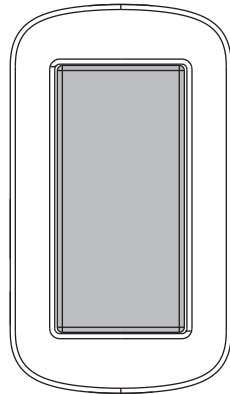
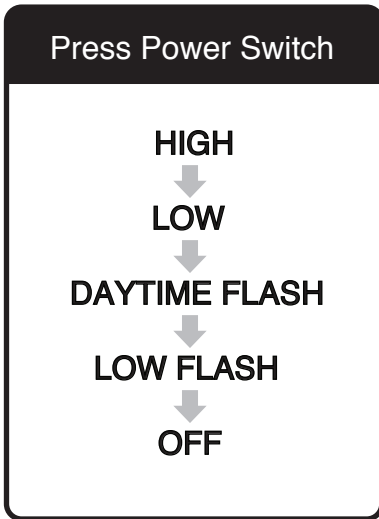

Mode	Lumens (Rear)	Runtime
HIGH	20	3hrs
LOW	10	6hrs
DAYTIME FLASH	40	12hrs
LOW FLASH	10	12hrs

\* Runtime & Luminosity might vary due to different condition

 **TIPS** Press and hold the switch to active TRY-ME mode for 5 seconds. The 2-blinking on power indicator will appear. Charge your light unit to deactivate TRY-ME mode.

### 4. BATTERY INDICATING

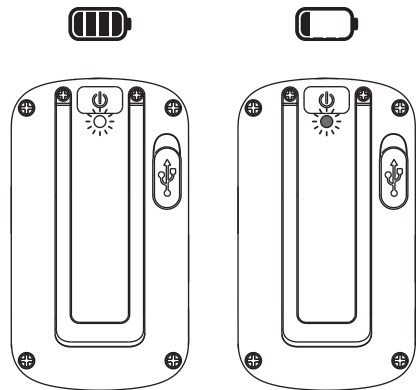

**POWER ON**  
indicator light-up in **GREEN**

**LOW POWER**  
indicator light-up in **RED**

 **TIPS** To view the battery indication level, the battery indicator will stay lit on for 4 seconds after the device is switched off.

### SPECIFICATION

Battery: Rechargeable Lithium-poly battery 550 mAh  
 LEDs: Multi-chips COB LED module  
 Charging plug type: Micro USB type-B  
 Temperature range: 14°F – 104°F ( -10°C – 40°C )  
 Recharge / Discharge number of times: About 350 times

\*The specification and modes are subject to change without notice.

 **CAUTION**  
 COB CHIPS EMIT VERY STRONG LUMINOSITY.  
 DO NOT LOOK INTO THE COB CHIPS WHEN SWITCHED ON.  
 HIGH LUMINOSITY CAN HARM YOUR EYES.